

## Integration of a housing estate in its surroundings

The site of the housing estate, Cité Louis Bertrand, is situated in a network of green corridors between the Porte d'Ivry and the Fort d'Ivry. The refurbishment of the housing estate is the opportunity to reinforce and integrate itself in the local urban fabric and to redefine its external spaces that had been neglected through a careless design. The parking lots have been grouped together and the circulation have been reduced to the minimum. The exterior areas have been allotted to different zones and functions and a new square at the entrance creates the new connection with its surrounding neighborhood.



### Reconnecting with the neighbourhood



### Defining quality spaces in the neighbourhood



- 1) Connecting the metro Pierre Curie to Louis Bertrand square
- 2) Extending the walk "Petits Bois"

- 3) Group the car park and release living spaces
- 4) Reorganize the hillside and the walk in the heart of the estate

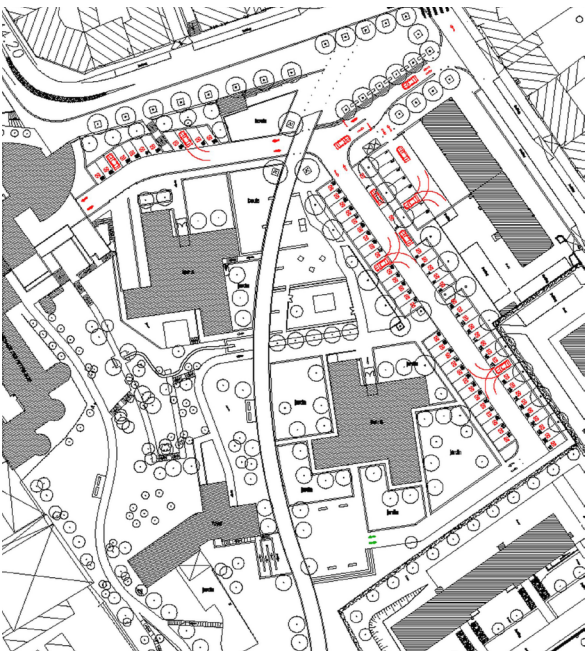

### Design of the square Louis Bertrand

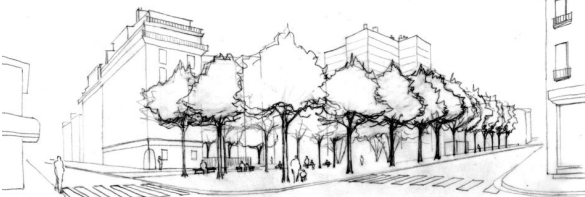

Call for tender: Urban study  
 Surface: 1,5 ha: Planning fees BT: 30 k€  
 Planning time: - Completion: 2004  
 Client: City of Ivry-sur-Seine  
 Espl G. Marrane F-94205 Ivry sur Seine  
 Location: Cité Louis Bertrand F-94000 Ivry-sur-Seine  
 Programme: External spaces of a housing estate  
 Mission: Integration of the housing estate in the city

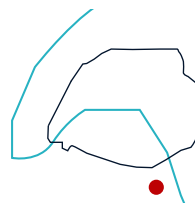

IVRY  
/SEINE

**CITE LOUIS BERTRAND - IVRY**  
 External spaces of a housing estate - Ivry-sur-Seine 2004

Urban planners with Olivier Baert - landscape architect



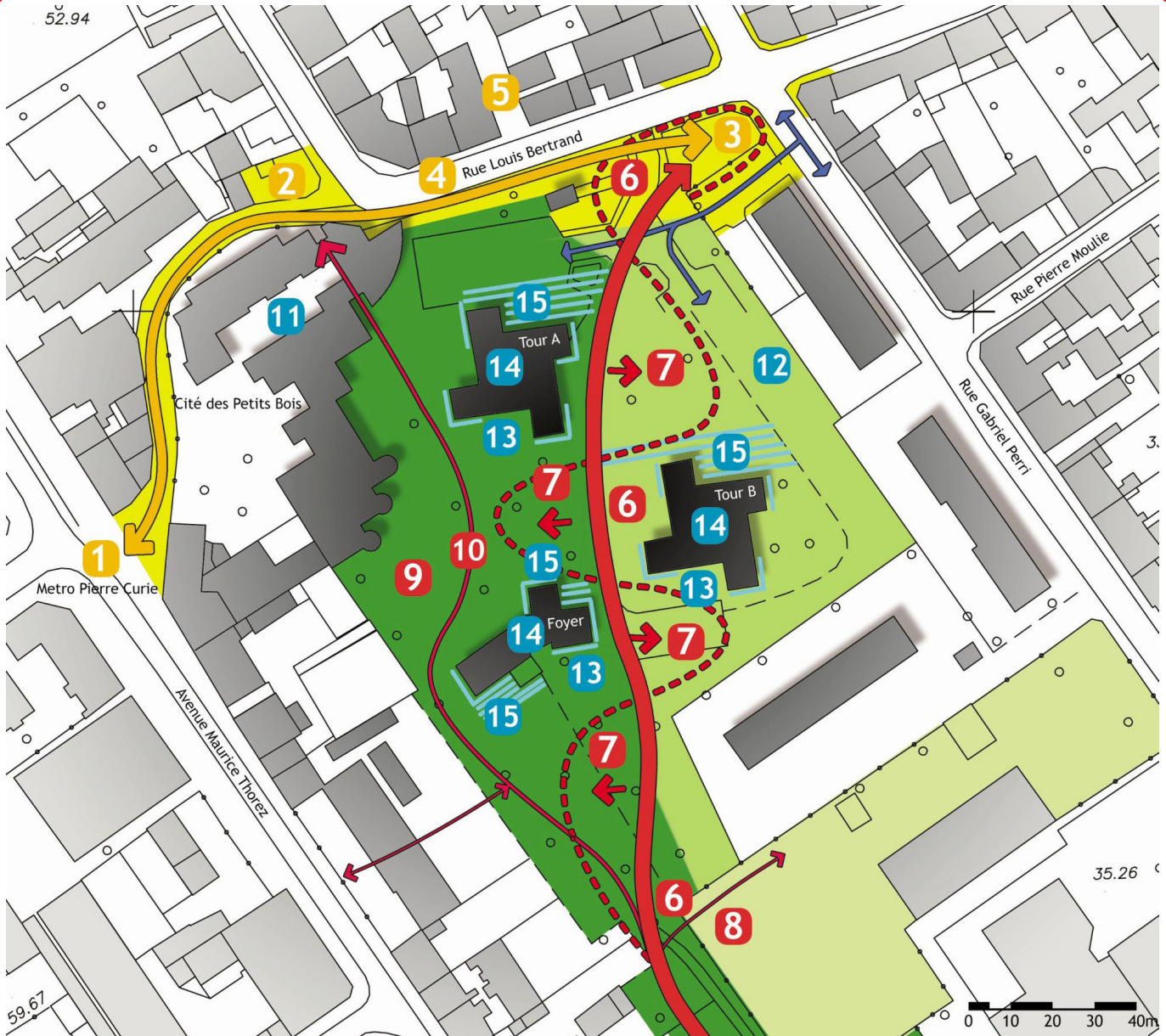

**Urban connection of the Pierre Curie subway to Louis Bertrand square:**

- 1 Requalification of C. Alphonso street with Pierre Curie square.
- 2 Extend C. Alphonso street on the square of the neighborhood house
- 3 Create Louis Bertrand square and move the car entrances to the residence.
- 4 Create a pedestrian promenade along Louis Bertrand street.
- 5 Requalification of the entrane of the A. Thomas street as part of the opening up of the island (see PLU).

**Extension of the Petits Bois promenade:**

- 6 Extend the Petits Bois promenade through the residence to Louis Bertrand square.
- 7 Preserving and redeveloping the living spaces of the residence along the promenade.
- 8 Allow a connection between the plot being planned and the Petits Bois promenade.
- 9 Strengthen the geographical identity of the wooded hillside.
- 10 Work the trails and control hillside erosion.

**Requalification of outdoor spaces and building surroundings:**

- 11 Securing and redeveloping the underground car park of the Petit Bois residence.
- 12 Consolidate parking lots on the Gabriel Péri street.
- 13 Work the buildings thresholds.
- 14 Affirm the buildings entrances (Towers A and B, Retirement Home)
- 15 Work the bases of walls and ground floors of buildings

Summary plan